

## CPV Processing

CPV processing ensures that funds from deposited checks are made available only after clearance is confirmed, adding a crucial layer of protection against check fraud. This method is more conservative and the availability of funds might take longer, as it depends on the CPV's specific processing timeline.

---

## Eligibility and Limits: Core-Based Configurations

Given the variety of configurations available for RDC across different banking cores, collaboration with your Access Softek and core implementation managers is key to tailoring the service for your financial institution (FI). Below, you will find links to a selection of user eligibility, deposit account eligibility, limits, and message configurations catered to some of the most widely-used cores. By examining these possibilities, you can more effectively determine which settings align best with your operational needs and strategic goals. These banking cores are covered:

- Symitar
  - Keystone
  - CUnify
- 

## Member Experience

### Deposit Screen

1

When a member attempts to access the mobile deposit screen, Access Digital sends a call to your core to request your eligible deposit accounts, user eligibility, and set limits. Ineligible members see the Ineligible message. Eligible members see the mobile deposit screen.

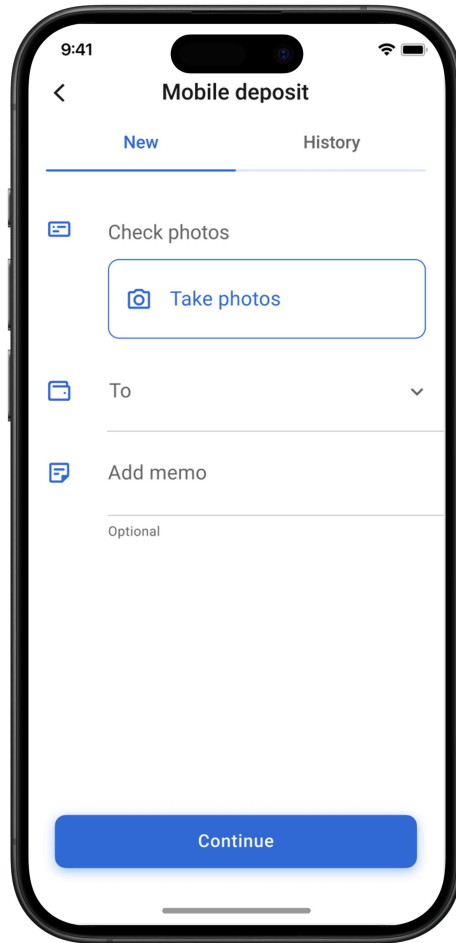
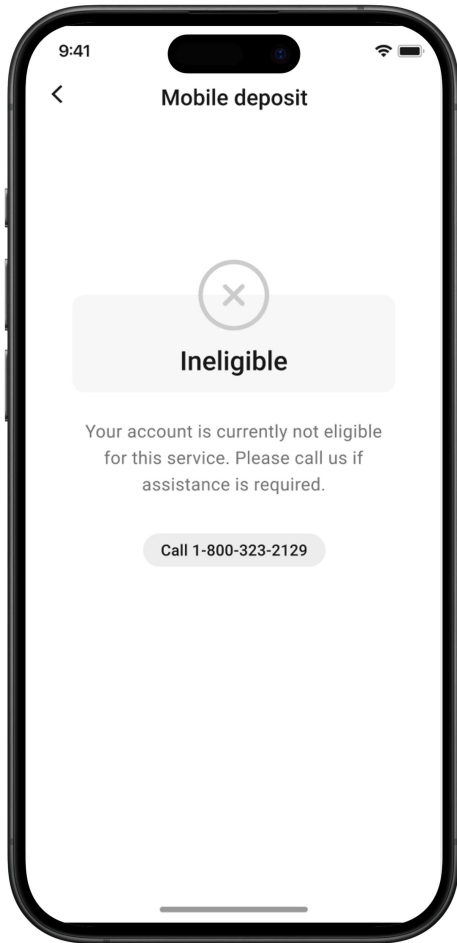

2

Eligible members can take a picture of the front and back of their check, choose an eligible deposit account, and enter the check details and an optional memo. If the check exceeds your set limits, Access Digital presents a message and won't deposit the check. If the check is within your set limits, Access Digital will deposit it to your CPV.

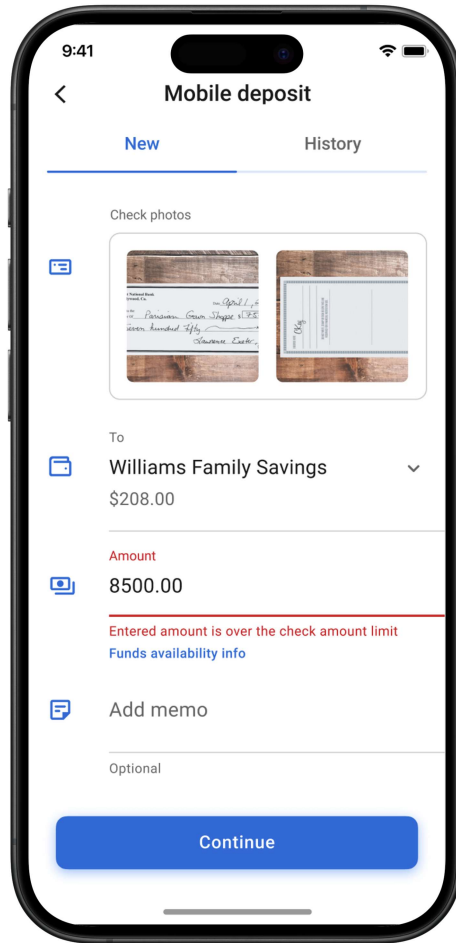
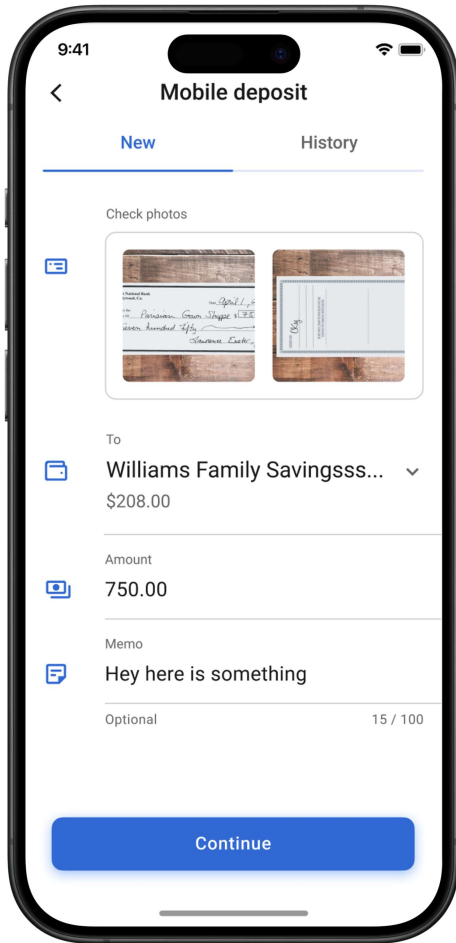

3

The CPV processes the check and returns the results to Access Digital. Access Digital will display the results to the member:

- **Success:** The CPV approved the check. The funds will become available based on the posting method you chose.
- **Rejected:** The CPV found an issue with the check and rejected it. For questions about rejections, consult your CPV.
- **Pending:** The check requires additional review. Your members can view status updates on their pending deposits in the History tab.

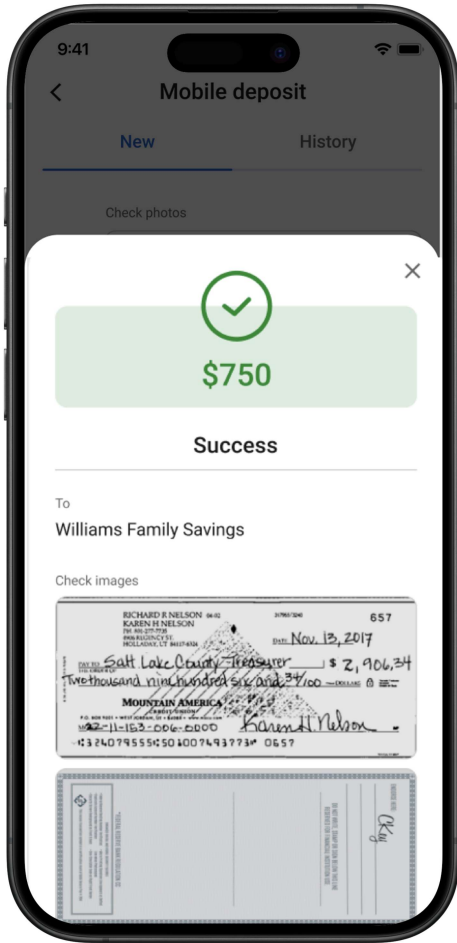

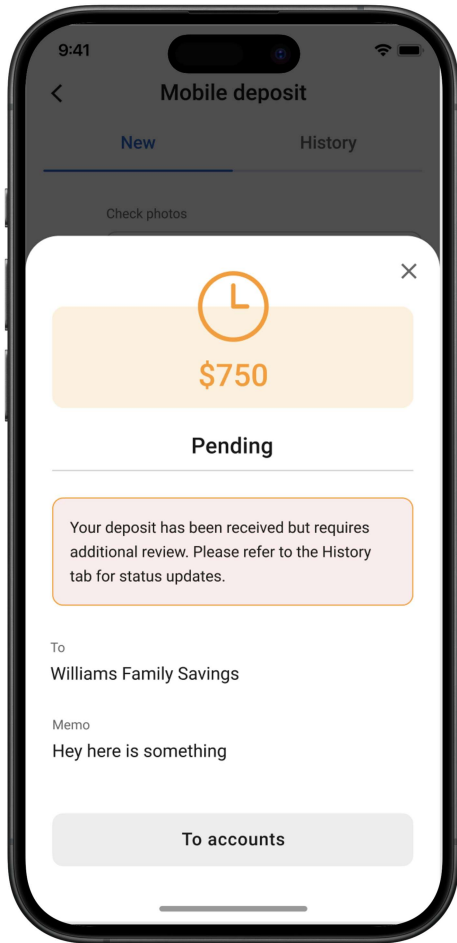

---

## History screen

RDC features a dedicated history page that displays the member's recent deposit submissions. This page provides details drawn directly from the CPV's admin system, including the current status of each deposit, pertinent deposit information, and images of the checks.

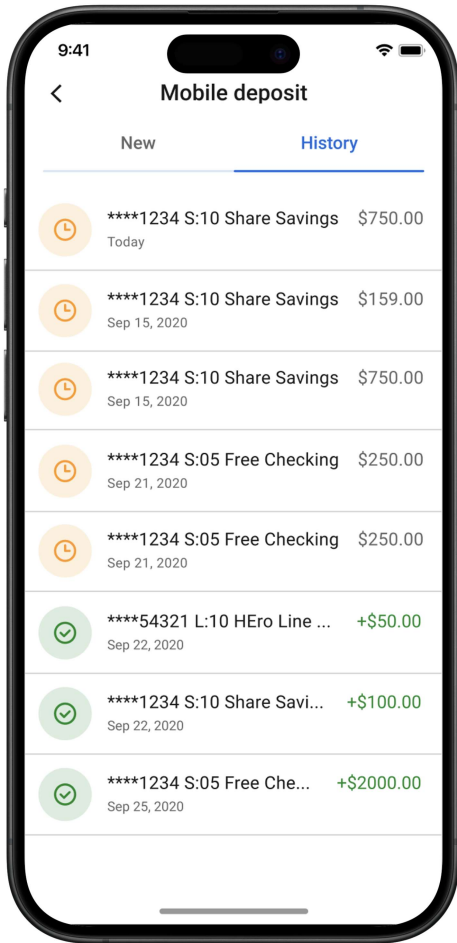

The CPV's system, not your core banking system, sources this historical data. Coordinate with your CPV representative to determine the amount of saved RDC history to display.

## Print Checks

You can allow your members to print check images directly from the main RDC History page, provided check images are available for their transactions. When this feature is enabled and a check image is ready, members will see a "Share Check Image(s)" button within the Transaction Info.

Upon clicking this button, the device's standard Share dialog pops up, presenting a Print option among other file-sharing choices. Members can select to print or use any other sharing method available.